



Thesis 2007

Pennsylvania State University
State College, PA 06802

KHA N DANG, LC INTERN
ARCHITECTURAL ENGINEERING
LIGHTING | ELECTRICAL option

T: 267 229 9370
E: knd107@gmail.com
W: www.arch.psu.edu/thesis/portfolio/2007/
portfolios/knd107

C: Dr. Richard Mistrick
C2: Ted Dannert

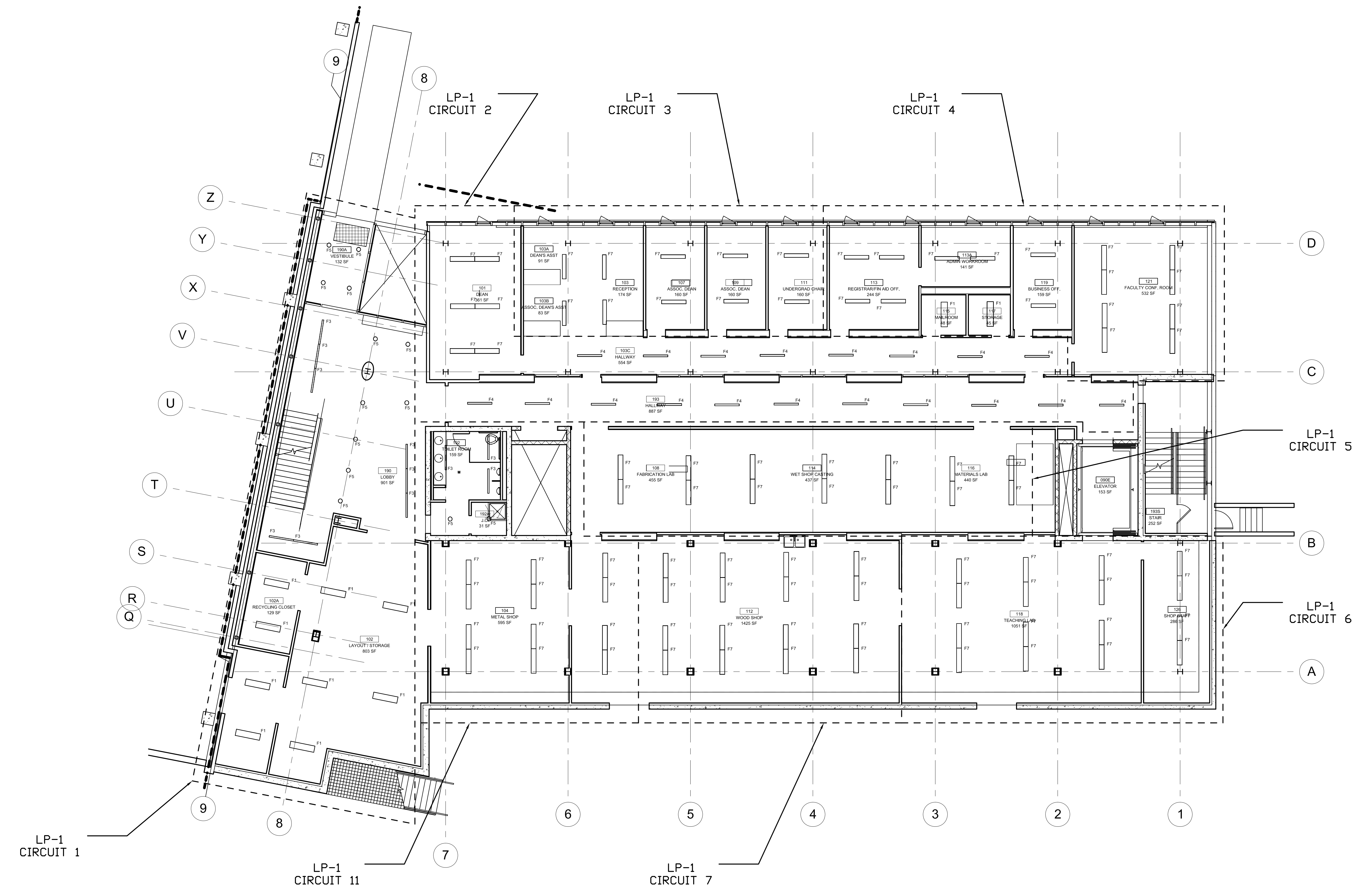

NOTE:

While great efforts have been taken to provide accurate and complete information, please be aware that the information contained herein is considered a work-in-progress for this thesis project. Modifications and changes related to the original building designs and construction methodologies for this senior thesis project are solely the interpretation of Kha N. Dang. Changes and discrepancies in no way imply that the original design contained errors or was flawed. Differing assumptions, code references, requirements, and methodologies have been incorporated into this thesis project; therefore, investigation results may vary from the original design.

NOT FOR CONSTRUCTION

NO.	DATE	REVISION

PROJECT NAME
**THESIS 2007
SCULPTURE BIDG
PARKING GARAGE**

BUILDING NAME & ADDRESS

PROJECT NUMBER

DRAWING TITLE
FIRST FLOOR CIRCUIT PLAN - 480Y/277V

SCALE
1/8"=1'-0"

DRAWN BY
KND

CAD FILENAME
XX-XX-XXX.DWG

DATE
03/11/07

DRAWING NUMBER

EP-102A